

Tool length measurement and tool breakage detection



Tool Setter TS40 series

High repeatability

1 μm or less

High repeatability ensures
quality machining

**High environmental
resistance**

IP67

New air-actuated lift
mechanism (Patent pending)
Prevent failures caused
by coolant and metal chips

Long operating life

**5 million
strokes**

Reliable non-contact magnetic
detection principle

Low measuring force

0.6 \pm 0.2 N

Low measuring force allows
small diameter tools to be used

▶ Tool length measurement and tool breakage detection

Can be used for both tool length
pre-setting and tool breakage detection.
Avoid scrap and increase productivity.

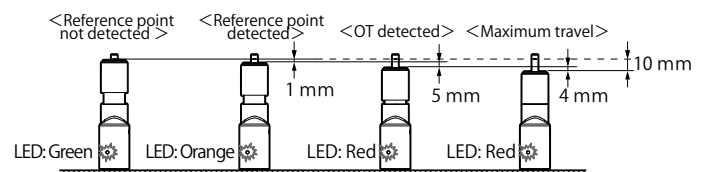

Damage may occur when moved more than 4mm after detection of OT signal*
Take measures to stop the machine immediately after detection of the OT signal
*OT signal=Over travel signal

Specification

Model name	TS40L2	TS41L2	TS42L2
Stroke length	10.5±0.5 mm		
Reference point	1.0±0.5 mm		
Reference point repeatability (at 20°C)	1 μm or less		
Response speed range	5 to 3,000 mm/min		
Number of strokes*1	5 million strokes		
Protection grade	IP67(Main unit only)		
Measuring force(at 20°C, reference point position)	0.6±0.2 N		
Power consumption	0.5 W		
Inrush current	0.5 A max.(Start up time after power on: 10 ms)		
Output specifications	Transistor output (Photo coupler isolation) Between output - COM MAX200V 0.5 mA - 0.1 A		
OT position (Over travel)	5.0±0.5 mm from reference point position		
Operating voltage range	12 V to 24 V DC		
Air pipe position*2	Right	Center	Left
Operating temperature	0 to +50 °C (No condensation)		
Storage temperature and humidity	-15 to +65 °C (90%RH max.)		

Model name

TS4□L2-○▽1G

▽	Conduit length
1	1 m
2	2 m
3	3 m
4	4 m
5	5 m

○	Cable length
2	2 m
3	3 m
4	4 m
5	5 m
6	6 m
7	7 m
8	8 m
9	9 m
A	10 m

□	Air pipe position *Please refer to the specification
0	Right
1	Center
2	Left

Attention: Select a conduit length that is shorter than the cable length

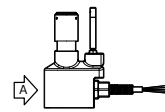

*1: Under specific conditions defined by Magnescale Co., Ltd.(Refer to the dimensions)
*2: When seen from the A direction in the above figure

Dimensions

TS40L2

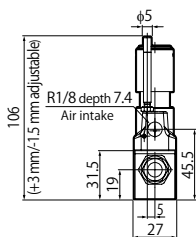

TS41L2



TS42L2

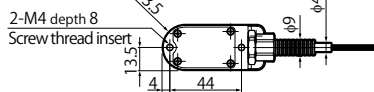
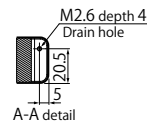
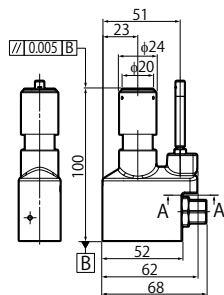
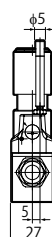

Unit : mm

Cable color	Signal
Purple	+V (12 V to 24 VDC)
Black	0 V
Blue	Reference point signal
Yellow	Reference point signal (COM)
Orange	OT signal
Gray	OT signal (COM)
Shielded wire	Connected to chassis

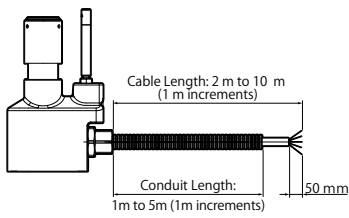

*Overall Conduit Length from main body
Conduit length to be at least 1 meter shorter than the overall cable length

Mounting example/Accessories

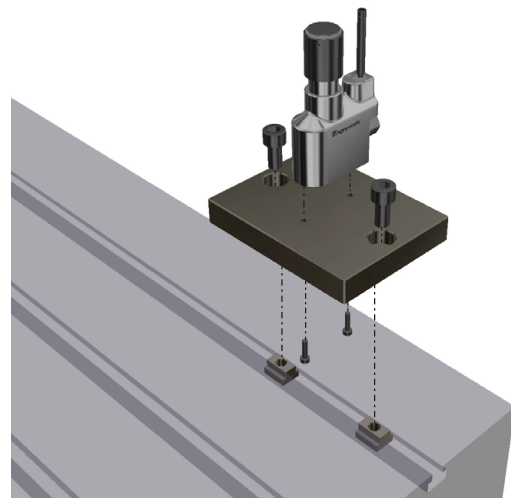

Optional Accessories

<Replacement parts>

- TZ40 tip set : Replacement tip for tool surface measurement 1
- Fixing screw HSS2x2(Conical tip) 3
- Hex wrench(Opposite side 0.9 mm) 1
- TZ41 pipe set : Replacement air pipe 1
- Fixing nut N4(mounted on the air pipe) 1

⚠ To use this product safely, please read the instruction manual carefully and thoroughly prior to usage. •Magnescale reserves the right to change products and specifications without prior notice.

Magnescale Co., Ltd.

International Sales Department 3-1-4 Edagawa, Koto-ku, Tokyo 135-0051, Japan
Magnescale Americas Inc. 1 Technology Drive, Suite F217, Irvine, CA 92618, USA
Magnescale Europe GmbH Antoniusstrasse 14, 73249 Wernau, Germany
Service & Parts 45 Suzukawa, Isehara-shi, Kanagawa 259-1146, Japan

TEL.+81(0)3-6632-7924
TEL.+1(949)727-4017
TEL.+49(0)7153-934-291
TEL.+81(0)463-92-2132

FAX.+81(0)3-6632-7928
FAX.+1(949)727-4047
FAX.+49(0)7153-934-299
FAX.+81(0)463-92-3090

E-mail : info-mgs-eng@magnescale.com
E-mail : info-am@magnescale.com
E-mail : info-eu@magnescale.com
E-mail : info-css@magnescale.com

<https://www.magnescale.com>

MAGNESCALE is a trademark or registered trademark of Magnescale Co., Ltd., Japan

TS40-EA01(01)M_M.200